



TIRE INFLATION
SOLUTIONS
FOR HEAVY
EQUIPEMENT

ABOUT EXACTRA

EXACTRA is a family-owned organization operating since 1988 and specializing in the manufacture of Large Bore (LB), Super Large Bore (SLB), Super Extra Large Bore (SXL), and Super Giant Bore (SGB) tire inflating valves as well as various related inflating systems.

Our mission has always been to be totally dedicated to the off-the-road tires used in mining operations as well as construction sites. Our goal is, and always will be, to supply the industry with superior products and service at a competitive price.

EXACTRA was founded by Maurice Robitaille offering over 50 years of hands on experience in the mining and construction sectors of the Off-The-Road tire application. The experience acquired spanned from servicing the tires, to field engineering, to sales and marketing as well as manufacturing inflating systems.

During the past 20 years EXACTRA has developed and introduced (1995) the Super Extra Large Bore (SXL) to the industry which has since been imitated by other manufacturers. More recently, EXACTRA developed the Super Giant Bore (SGB) line of products which is an improved version of a similar product on the market.

Currently, with a view of providing more safety for the tire servicemen, EXACTRA has introduced an improved model of inflating adaptor for the Super Large Bore (SLB), Super Extra Large Bore (SXL) and Super Giant Bore (SLB). The features of this improved model can be seen on pages 8, 13 and 22 of this catalogue.

EXACTRA has the ability and expertise to develop special requirements such as high heat resistant hoses for applications where there is heat being generated due to high speeds, long hauls, heavy loads and/or vehicle design.

SYSTEMS COMPARISON

There are four different systems available to inflate OFF-THE-ROAD (OTR) tires, as follows:

LARGE BORE (LB)

Although identified as *LARGE BORE*, it does not really reflect the effectiveness when in use, as the actual bore is a mere 3/16". However, when originally introduced, it did offer a significant improvement over the *STANDARD* bore products.

SUPER LARGE BORE (SLB)

Introduced in the early 1970, *SUPER LARGE BORE* featured a huge improvement in the required time to inflate a large tire. The bore was improved from 3/16" to just under 1/2". It is still one of the most popular systems, primarily because of minimum clearance needed over the *SUPER EXTRA LARGE* and *SUPER GIANT* bores. It is also the most cost effective system.

SUPER EXTRA LARGE BORE (SXL)

Introduced by EXACTRA in mid 1990's, it improved the bore to just under 5/8" thus reducing inflation time by as much as 50% over the *SUPER LARGE BORE* system. Since the various components are somewhat larger than those of the *SUPER LARGE BORE*, the application is limited to where there is sufficient clearance between the wheel/rim and the drive/braking assembly.

SUPER GIANT BORE (SGB)

This system was introduced by EXACTRA during the last decade. It offers a similar flow as that of another product of same bore, but is more user friendly. The bore was improved from just under 5/8" for *SUPER EXTRA LARGE* to just under 3/4" allowing for a further reduction in inflation time by as much as 50% over the *SUPER EXTRA LARGE* bore. Here the application is also restricted to vehicles that offer sufficient clearance between the wheel/rim and the drive/braking assembly.

LARGE BORE
0.19" / 4.826 mm



SUPER LARGE BORE
0.44" / 11.176 mm



SUPER EXTRA LARGE BORE
0.56" / 14.224 mm



SUPER GIANT BORE
0.69" / 17.526 mm

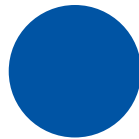

VALVE SYSTEM	INFLATION TIME	VALVE HOLES	INFLATOR REQUIRED	FOR TIRE SIZES
LARGE BORE (LB)		13/16" – 1/2" NPT	LARGE BORE CHUCK	UP TO 25"
SUPER LARGE BORE (SLB)	100 LEVEL	13/16" – 1/2" NPT	EX-900S or EX-95ADK	UP TO 57"
SUPER EXTRA LARGE BORE (SXL)	50% of 100 LEVEL	13/16" – 1/2" NPT	SXL-900S or EX-95ADK	UP TO 69"
SUPER GIANT BORE (SGB)	50% OF SXL	15/16" – 3/4" NPT	SGB-900S or EX-95ADK	UP TO 69"

SAFETY PRECAUTIONS

Tire and Rim Servicing can be dangerous, and should only be performed by trained personnel using the proper tools and procedures.

Failure to comply with these procedures as well as procedures recommended by Tire, Wheel and/or Rim Manufacturers may result in faulty positioning of the tire and rim and cause the assembly to burst with explosive force sufficient to cause serious physical injury or death.

The following safety precautions relate to the safe use of EXACTRA products:

- DO use the proper valves for all applications. The approach of one size fits all is never a good one as it leads to failure.
- DO use one piece valve whenever possible to minimize joints.
- DO tighten all connections only to recommended torque. It is not a strongman contest.
- DO make sure the proper matching rim and wheel components are used.
- DO inspect all rim and wheel components for damage such as cracks.
- DO make sure all components are clean and free of rust.
- DO use a proper lubricant on all rim parts to facilitate tire seating and prevent rusting.
- DO use a liquid type lubricant for the O-ring for proper seating and prevent pinching.
- DO use proper tools for the job.
- DO inflate tires to the T.R.A. Recommended pressure for the application.
- DO check service gauges against a master gauge on a daily basis.
- DO use proper inflating adaptors for the bore (i.e. EX-900S-L for Super Large Bore.)
- DO check air pressures daily, because the tire in itself does not carry the load, but rather serves the purpose of being a pressure container for the purpose of carrying the load. The proper inflation pressure is one important factor in extending the life of the tire.
- DO use an inflating device, with sufficient hose length, to ensure the serviceman's safety and use proper retaining device in event of components failing to engage properly.
- DO NOT change the bend angle of a valve as it puts extra stress in the area of the bend. There are valves made with proper angle bend for all applications.
- DO NOT use extensions unless absolutely necessary. They can be a source of leakage.
- DO NOT overtighten any of the connections as this can lead to early failure.
- DO NOT use an improper flange or lock ring.
- DO NOT use components that show signs of damage.
- DO NOT fit tires on bead seat areas that have rust buildup.
- DO NOT use petroleum or heavy based lubricants.
- DO NOT use inadequate tools. There are proper tools for each job.
- DO NOT assume that the tire is at proper pressure. Do not reduce pressure in a hot tire.
- DO NOT use a large bore chuck on super large bore as this defeats the advantages.
- DO NOT mishandle gauges as they can be decalibrated if dropped or thrown in the box.
- DO NOT stand in front of the tire and rim assembly during the inflation/deflation process.

TABLE OF CONTENTS (cont'd)

Systems Comparison	1
Safety Precautions	2
SUPER GIANT BORE (SGB)	
Complete Valve Assemblies.....	4
Flexible Tubing, Assembly Tool, Swivel Angle Connectors, Rim Spuds.....	5
Core Housing, Jam Nuts, Connectors, Sleeves, Flexible Extension Assembly Kits.....	6
Straight Valve Assemblies, Swivel Valve Assemblies, Spud/Connector	7
Inflator Adaptors	8
SUPER EXTRA LARGE BORE (SXL)	
Complete Valve Assemblies, Flexible Extensions.....	9
Rigid Swivel Valve, Angle Connectors, Assemblies, Loader Valve, Valve Extensions.....	10
Extension Assembly Tool, Flexible Tubing, Spuds, Connectors.....	11
Core Housing, Jam Nuts, Swivel Connectors, Sleeves, Flexible Extension Assembly Kits.....	12
Inflator Adaptors.....	13
SUPER LARGE BORE (SLB)	
Complete Valve Assemblies, Flexible Extensions	14
Flexible Extensions, Double Spud Valve Assembly, Rigid Swivel Valve Assemblies.....	15
Rigid Turret Valve Assemblies, Flexible Tubing, Assembly Tool	16
Core Housing, Jam Nuts, Swivel Connectors, Sleeves, Assembly Kits.....	17
Core Housings, Valve Assemblies, Out-In Spud, Loader Valve	18
Screw-In Angle Spuds, Clamp-In Connector, Swivel Angle Connectors	19
Spuds	20
Plug, Valve Cap, Assembly Tool, Swivel Valve, Custom Valves	21
Inflator Adaptors.....	22
LARGE BORE (LB)	
Single-Bend Swivel Valves.....	23
Multiple-Bend Swivel Valves, Turret Valves	24
Repair Valves, High Bend Valves, Loader Valve, Tank Valve	25
Special Formed Valves.....	26
Rim Spud, Screw-In Spud, Out-In Spud, Hole Plug, Adaptors.....	27
Straight Valves, Caps, Long & Short Valve Cores	28
Rigid Extensions, Hand Bendable Extensions, Flexible Extensions, Extension Assembly Kit	29
TRACTOR/GRADER & SMALL LOADERS	
Air Water Valves, Air Water Valve Extensions	30
Air Water Assembly, Core Housings, Rim Hole Plug, Brass/Chrome Valves, Rim Nuts.....	31
Tank Valves, Liquid Fill Tool	32
TRUCK & BUS VALVES	
TR570 Series Valves, O-Ring Series Valves.....	33
V3-20 Valves, Enkei Valves, Alcoa Valves & Low Profile Valves, Small Clamp-In Valves	34
Screw-On Repair Valves	35
Valve Extensions, Flexible Extensions, Bent Extensions	36
PASSENGER & LIGHT TRUCK	
Snap-In Valves, Metal Extension Caps, Standard Valve Cores, Standard Valve Caps	37
DIAL GAUGES & DIGITAL GAUGES	
Standard/Large Bore Dial Gauges, Pocket Dial Gauge, Digital Pressure Gauge	38
Large Bore Digital Pressure Gauges, Precision Dial Gauges	39
Pocket Type Gauges, Dual Foot Gauges, Swivel Foot Gauges, Recalibrateable Gauges	40
TOOLS	
Tire Technicians Tool Kits, Standard Bore Tube Deflator, Core Removal Tools.....	41
Valve Core Tools, Valve Cap Tools, Extractor Tools, Valve Fishing Tools	42
Valve Core Tools, Tire Tread Depth Gauges	43
INFLATORS	
Standard Bore Inflators, Large Bore Inflators, Standard/Large Bore Dual Inflators	44
Standard Bore Inflators, Large Bore Inflators, Precision Large Bore Inflators	45
CHUCKS	
Ball Foot Chucks, Clip-On Chucks, Screw-On Chucks, Lock-On Chucks	46
Clip-On Chucks, Dual Foot Chucks	47
O-RINGS & L-RINGS & GROMMETS	48

SUPER GIANT BORE (SGB)

COMPLETE VALVE ASSEMBLIES

SUPER GIANT BORE

EXACTRA's SUPER GIANT BORE (SGB) line up now features additional spuds & swivel connectors to be compatible with some of the MEGA BORE components. These two new parts are identified in the SGB-700 series as follows: SGB-715 Screw-in Spud, SGB-725 Clamp-in Spud as well as SGB-775, SGB-785, SGB-790 which are all Swivel Connectors of various angles.

The SGB-715 & SGB-725 will accept the MEGA BORE MB-29-85 connector. The SGB-775, SGB-785 & SGB-790 swivel connectors will accept the MEGA BORE MB-20 spud.



SGB-130-##

Complete swivel valve assembly including SGB-110 (core housing) and SGB-120 (clamp-in spud). It is used primarily on tire sizes 57" and 63" where there is sufficient clearance between the wheel and drive mechanism.

When ordering simply indicate the length required by replacing the "-##". For example a 36" assembly would be ordered as follows: SGB-130-36



SGB-730-##

Basically same as SGB-130 except for the SPUD & SWIVEL connector which are designed to be compatible with some of the MEGA BORE components. The spud is SGB-725 & the swivel connector is the SGB-790.

When ordering simply indicate the length required by replacing the "-##". For example a 36" assembly would be ordered as follows: SGB-730-36



SGB-131-##

Same as SGB-130 & SGB-730 except without the SGB-120 or SGB-725 spuds.

SGB-135-## Flexible Extension

Flexible extension only.

When ordering simply indicate the length required by replacing the "-##". For example a 36" assembly would be ordered as follows: SGB-135-36



SUPER GIANT BORE (SGB)

FLEXIBLE TUBING, ASSEMBLY TOOL, SWIVEL ANGLE CONNECTORS, RIM SPUDS

SGB-165 Flexible Tubing

Tubing to make up SGB-130 series flexible extensions. Inside diameter is $\frac{3}{4}$ ". Available in 100' rolls.



SGB-165

SGB-950 Assembly Tool

Assembly tool used in field operations to make up SGB-130 series flexible extensions.



SGB-950

SGB Swivel Angle Connectors (100 series)

Swivel angle connectors to fit on SGB-120 clamp-in spud and SGB-115 screw-in spud. They are available in a variety of angles as shown below:

SGB-190 - 90° SGB-185 - 85° SGB-175 - 75°
SGB-170 - 70°



SGB-185

SGB Swivel Angle Connectors (700 series)

Swivel angle connectors to fit on SGB-725 clamp-in spud and SGB-715 screw-in spud. They are available in a variety of angles as shown below:

SGB-790 - 90° SGB-785 - 85° SGB-775 - 75°



SGB-785

SGB-115 Rim Spud

The SGB-115 rim spud fits $\frac{3}{4}$ " NPT tapped rim hole and is designed for the SGB-175, 185 & 190 swivel connectors. Accepts the SGB-110 core housing.

SGB-715 Rim Spud

The SGB-715 rim spud fits $\frac{3}{4}$ " NPT tapped rim hole and is designed for the SGB-775, 785 & 790 swivel connectors but WILL NOT accept the SGB-110 core housing.



SGB-115

SGB-120 Rim Spud

The SGB-120 rim spud for a $\frac{15}{16}$ " rim hole is designed for the SGB-175, 185 & 190 series of swivel connectors and will accept the SGB-110 core housing.

SGB-725 Rim Spud

The SGB-725 rim spud for a $\frac{15}{16}$ " rim hole is designed for the SGB-775, 785 & 790 series of swivel connectors but WILL NOT accept the SGB-110 core housing.



SGB-120

SUPER GIANT BORE (SGB)

CORE HOUSING, JAM NUTS, CONNECTORS, SLEEVES, FLEXIBLE EXTENSION ASSEMBLY KITS



SGB-110

SGB-110 Core Housing

Core housing for all SGB line of products.



SGB-100

SGB-100 Jam Nuts

Jam nuts used on SGB-120 & SGB-725 clamp-in spuds and also to tie down longer valve assemblies.



SGB-155

SGB-155 Swivel Connector

Swivel connector used in production of SGB-130 series flexible assemblies in order to attach to the various angle connectors.



SGB-150

SGB-150 Straight Connector

Straight connector used in production of SGB-130 series flexible assemblies to accept the SGB-110 core housing.



SGB-125

SGB-125 Sleeves

Sleeves used on SGB-130 series of flexible extensions to retain tubing onto SGB-150 & SGB-155 connectors.



SGB-160

SGB-160 Flexible Extension Assembly Kit

Kit made up of following components for field assembling of flexible extensions:

- 1 each of SGB-110, SGB-150, SGB-155
- 2 each of SGB-125, SGB-100

SGB-160/1 Flexible Extension Assembly Kit

Kit made up of following components for field assembling of flexible extensions:

- 1 each of SGB-150, SGB-155
- 2 each of SGB-125, SGB-100

SGB-141 Straight Valve Assembly

Straight valve assembly consisting of SGB-115 screw-in spud and SGB-110 core housing.



SGB-141

SGB-140 Straight Valve Assembly

Straight valve assembly consisting of SGB-120 clamp-in spud and SGB-110 core housing.



SGB-140

SGB-145 Swivel Valve Assembly

SGB-145 swivel valve, consisting of SGB-120 spud, SGB-190 connector and SGB-110 core housing.



SGB-145

SGB-745 Swivel Valve Assembly

SGB-745 swivel valve is meant to be compatible with MEGA BORE spuds. It is similar to SGB-145, but consists of SGB-725 spud, SGB-790 connector and SGB-110 core housing.



SGB-285

SGB-285 Spud/Connector

85° angle screw-in spud/connector to fit into 3/4" NPT threaded valve hole.

SUPER GIANT BORE (SGB)

INFLATOR ADAPTORS

SGB-900S-L Inflator Adaptor



SGB-900S-L

Inflator adaptor for SGB line of products. Allows faster inflation/deflation of giant tires. This inflator allows air line connections of either 1/2" NPT male or 3/4" NPT female threads. It also features safety factors inasmuch as the union attaches to the main body by means of a left hand thread thus preventing accidental detaching of the union during the operation of attaching the union to the valve assembly.

The core housing and cap are recessed within the handle to prevent injury to the service man.

SGB-900S-L Components

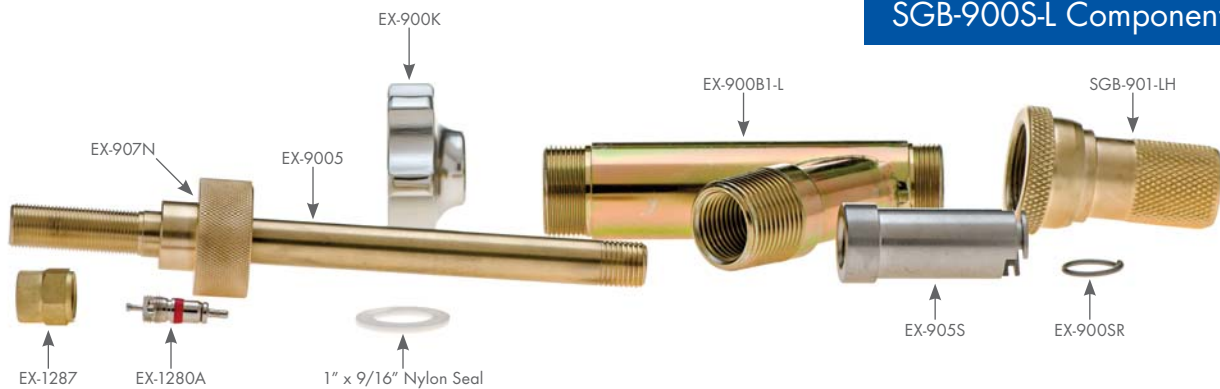

EX-95-ADK Inflator Adaptor

Inflator adaptor with same features as SGB-900S-L but can be used for any of the SUPER LARGE BORE, SUPER EXTRA LARGE BORE and SUPER GIANT BORE simply by attaching the corresponding union.

It is delivered complete with the three unions.



SUPER EXTRA LARGE BORE (SXL)

COMPLETE VALVE ASSEMBLIES, FLEXIBLE EXTENSIONS

SUPER EXTRA LARGE BORE

The SUPER EXTRA LARGE BORE, also known as SUPER XL (SXL) line of products features a significant improvement in inflation time required to inflate large OTR tires. It reduces the inflation time required by approximately 50% when compared to the SUPER LARGE BORE.

The part numbers for this line of products have the prefix "SXL" in front of each number wherever possible.



SXL-1650-## Valve Assembly

Complete swivel valve assembly, including SXL-1050 core housing and a SXL-1008 clamp-in spud. It is used primarily on tires 57" and 63" where there is sufficient clearance between the wheel and drive mechanism.

When ordering simply indicate the length required by replacing the "-##". For example a 36" assembly would be ordered as follows: SXL-1650-36



SXL-1600-## Valve Assembly

Basically the same as SXL-1650, but without the SXL-1008 clamp-in spud. When ordering you must specify the effective length required.



SXL-1800-## Flexible Extension

Flexible extension only.

When ordering simply indicate the length required by replacing the "-##". For example a 36" assembly would be ordered as follows: SXL-1800-36



SXL-1801-## Steel Braided Flexible Extension

Same as SXL-1800 except that it is made with STEEL BRAIDED hose featuring a much better resistance to heat, abrasion as well as a much tighter bend radius. Because of the heavier hose it requires heavy duty fittings and can only be assembled in house. The ordering procedure is the same as others meaning you must specify length required from end to end.

These extensions are primarily used where there is a tremendous amount of heat generated related to long haul, high speed, heavy loads combined with low clearance between drive/brake mechanisms and wheel assembly.

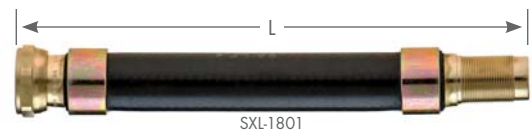

SUPER EXTRA LARGE BORE (SXL)

RIGID SWIVEL VALVE, ANGLE CONNECTORS, ASSEMBLIES, LOADER VALVE, VALVE EXTENSIONS

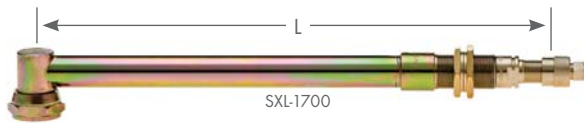

SXL-1700

SXL-1700-## Rigid Swivel Valve Assembly

Rigid swivel valve assembly. Includes SXL-1050 core housing & 2 SXL-1000 jam nuts. It can be fitted on SXL-1008, SXL-1008L and SXL-1009 spuds. When ordering length, you should specify as per effective length.

Also available with SXL-1008 spud under part number SXL-1900-##.



SXL-1010

SXL Swivel Angle Connectors

All SXL swivel angle connectors fit onto SXL rim spuds (SXL-1008, SXL-1008L, SXL-1005 and SXL-1009). These swivel connectors are used to join the flexible extensions to the rim spuds. They are available in a variety of angles as shown below:

SXL-1010 - 90°
SXL-1014 - 75°

SXL-1012 - 85°
SXL-1015 - 60°

SXL-1013 - 80°



SXL-1500

SXL-1500 Swivel Assembly

Swivel valve assembly consisting of SXL-1050 housing and SXL-1010 connector.



SXL-2000

SXL-2000 Straight Assembly

Straight valve assembly, made up with SXL-1008 clamp-in spud and SXL-1050 core housing. It can also be supplied with the SXL-1008L which is the longer version of the SXL-1008 with 0.20" more height.



SXL-1007

SXL-1007 Loader Valve

Loader Valve for SXL series.

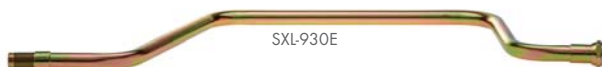

SXL-930E

SXL-930E Valve Extension

Komatsu 930E formed valve extension.



SXL-930E3

SXL-930E3 Valve Extension

Komatsu 930E3 formed valve extension.

SUPER EXTRA LARGE BORE (SXL)

ASSEMBLY TOOL, FLEXIBLE TUBING, SPUDS, CONNECTORS

SXL-1008 Clamp-in Spud

Clamp-in spud to fit into 13/16" rim valve hole. Can also be used in the 15/16" rim valve hole, providing the clamping nut is installed with the recessed shoulder towards the rim which is designed to fit into the rim hole in order to center the spud properly. This spud will accept all of the SXL swivel connectors as well as SXL-1050 core housing.



SXL-1008

SXL-1008L Clamp-in Spud

Clamp-in spud offering same features as SXL-1008 except that it is 0.20" higher than the SXL-1008.



SXL-1008L

SXL-1005 Screw-in Spud

Screw-in spud for SXL swivel connectors. Fits into 1/2" NPT threaded valve hole.



SXL-1005

SXL-1009 Screw-in Spud

Screw-in spud for SXL swivel connectors. Fits into 3/4" NPT threaded valve hole.



SXL-1009

SXL-1006 Screw-in Connector

85° Screw-in connector – fits into 1/2" NPT threaded valve hole.



SXL-1006

SXL-1018 Screw-in Connector

85° Screw-in connector - fits into 3/4" NPT threaded valve hole.



SXL-1018

SXL-1290 Assembly Tool

Tool to assemble flexible extension in field operation.



SXL-1290

SXL-1075 Flexible Tubing

Flexible tubing (5/8" ID) to make SXL flexible extensions. Available in 100' rolls.



SXL-1075

SUPER EXTRA LARGE BORE (SXL)

CORE HOUSING, JAM NUTS, SWIVEL CONNECTORS, SLEEVES, ASSEMBLY KITS



SXL-1050

SXL-1050 Core Housing

Core housing used with the SXL angle connectors, flexible extensions and various spuds.



SXL-1000

SXL-1000 Jam Nuts

Jam nut used on various SXL components.



SXL-1030

SXL-1030 Swivel Connector

Swivel connector used to make various SXL flexible extensions. Attaches to various SXL angle connectors.



SXL-1020

SXL-1020 Straight Connector

Straight connector used to make various SXL flexible extensions.



SXL-1040

SXL-1040 Sleeves

Sleeve used to retain the tubing onto the barb fittings of the flexible extensions.



SXL-1400K Flexible Extension Assembly Kit

Kit made up of following components for field assembling of flexible extensions:

- 1 each of SXL-1050, SXL-1020, SXL-1030
- 2 each of SXL-1000, SXL-1040

SXL-1401K Flexible Extension Assembly Kit

Kit made up of following components for field assembling of flexible extensions:

- 1 each of SXL-1020, SXL-1030
- 2 each of SXL-1000, SXL-1040

SXL-900S-L Inflator Adaptor

Inflator adaptor for SXL line of products. Allows faster inflation/deflation of giant tires. This inflator allows air line connections of either 1/2" NPT male or 3/4" NPT female threads. It also features safety factors inasmuch as the union attaches to the main body by means of a left hand thread thus preventing accidental detaching of the union during the operation of attaching the union to the valve assembly.

The core housing and cap are recessed within the handle to prevent injury to the service man.



SXL-900S-L

SXL-900S-L Components

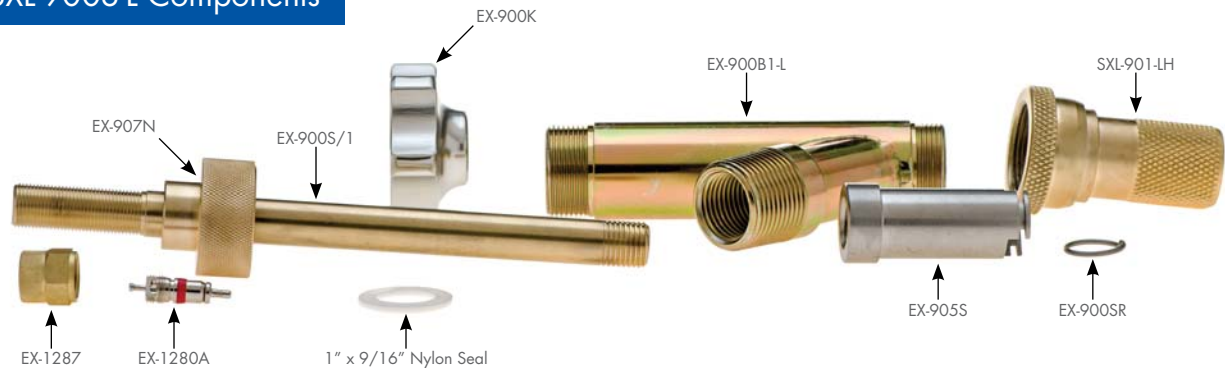

EX-95-ADK Inflator Adaptor

Inflator adaptor with same features as SXL-900S-L but can be used for any of the SUPER LARGE BORE, SUPER EXTRA LARGE BORE and SUPER GIANT BORE simply by attaching the corresponding union.

It is delivered complete with the three unions.



SUPER LARGE BORE (SLB)

VALVE ASSEMBLIES, FLEXIBLE EXTENSIONS

SUPER LARGE BORE

The SUPER LARGE BORE was the first improvement over the LARGE BORE system. Introduced during the early 1970s, it offers a vast improvement in inflation time required to inflate the larger tires being introduced to the market at that time.

It is still the most popular of the larger bores available today; however it requires the use of a special inflator to fully take advantage of the larger bore.

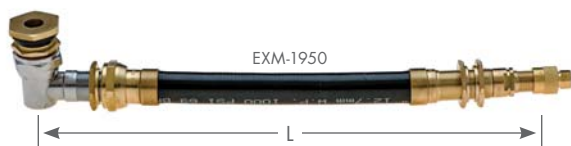

EXM-1950-## Valve Assembly

Complete swivel valve assembly including EXR-520 core housing and EXT-81 clamp-in spud. It is primarily used on tires sizes up to 57". When ordering you must specify effective length required which is measured from the center of the swivel connector to the end of the core housing. For example a 36" valve should be ordered as follows: EXM-1950-36

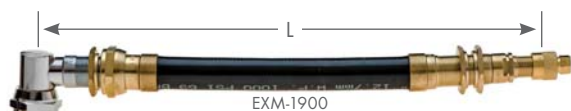

EXM-1900-## Valve Assembly

Basically the same as EXM-1950 but supplied without the clamp-in spud. When ordering you must specify the effective length required.



EXM-3000-## Flexible Extension

Flexible extension only used to make up the EXM-1900 series assemblies. When ordering you must specify effective length required which is measured from end to end.



EXM-3000HD-## Steel Braided Flexible Extension

Same as EXM-3000 except it is made with STEEL BRAIDED HOSE featuring better resistance to heat, friction and kinking. These heavy duty extensions can be reused time and again thus reducing the end cost. When ordering you must specify effective length required which is measured from end to end.

EXDS-226 Connector

Straight barb connector for EXM-4000 series extensions.



EXDS-226

EXDS-296-## Valve Assembly

Super large bore double spud valve assembly. Designed for applications where clearance space is critical. Valve height above the rim is only 0.875". Assembly consists of either EXDS-210 clamp-in type spud or EXDS-210P 1/2" NPT screw-in spud, EXDS-215 plug, EXM-4000 extension and EXR-520 core housing.

When ordering you must specify effective length required which is measured from the middle of the double spud to the end of the core housing. For example for a 29" assembly you would order EXDS-296-29.



EXDS-296

EXM-4000-## Flexible Extension

Flexible extension used to make up EXDS-296 series assemblies. When ordering you must supply effective length required which is measured from end to end. For example for 29" assembly you would order EXM-4000-29.



EXM-4000

EXM-4000HD-## Steel Braided Flexible Extension

Same as EXM-4000 except that it is made with STEEL BRAIDED HOSE featuring better resistance to heat, friction and kinking. These heavy duty extensions can be reused time and again. Ordering procedure is the same as that of the EXM-4000.



EXM-4000HD

EXMR-800-## Rigid Swivel Valve

Rigid swivel valve assembly. Includes EXR-520 core housing & 2 EXB-222 jam nuts. It can be fitted on EXT-81, EXT-82 and EXC-100 spuds.

Also available with EXT-81 clamp-in spud under part number EXMR-850-##.

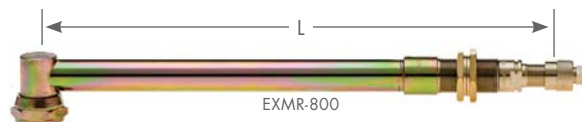

EXMR-800

EX-1239 Rigid Swivel Valve Assembly

Complete rigid swivel valve assembly for CAT-793, delivered with EXR-520 core housing but without rim spud. Will fit onto EXT-81, EXT-82 & EXC-100 rim spuds.

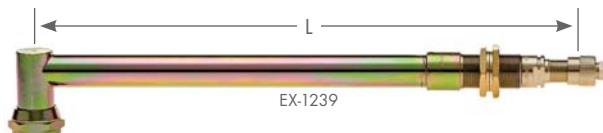

EX-1239

SUPER LARGE BORE (SLB)

RIGID TURRET VALVE ASSEMBLIES, FLEXIBLE TUBING, ASSEMBLY TOOL



EXMR-890-## Rigid Turret Valve Assembly

Turret type super large bore rigid valve assembly. Fit into 13/16" rim valve hole. Supplied with heat resistant Viton grommet.



EX-117-0764 Rigid Turret Valve Assembly

Super large bore turret type valves for Caterpillar 980D medium wheel loaders. They are completely produced with brass material for longer life where calcium chloride type ballast is used. They are also supplied with heat resistant Viton grommet.



EX-144-0290 Rigid Turret Valve Assembly

Super large bore turret type valves for Caterpillar 988G large wheel loaders. They are completely produced with brass material for longer life where calcium chloride type ballast is used. They are also supplied with heat resistant Viton grommet.



EX-146-6779 Rigid Turret Valve Assembly

Super large bore turret type valves for Caterpillar 980G medium wheel loaders. They are completely produced with brass material for longer life where calcium chloride type ballast is used. They are also supplied with heat resistant Viton grommet.



EXR-760 Flexible Tubing

Flexible tubing used to make up the SUPER LARGE BORE flexible extensions. Available in 100' rolls.



EXR-760HD Heavy Duty Flexible Tubing

Steel braided hose to make up SUPER LARGE BORE flexible extensions for use in extreme conditions such as heat, friction and/or collapsing/kinking. Because of the superior quality of the hose, these extensions can be reused time and again.



EX-990 Assembly Tool

Tool to assemble flexible extension in field operation.

EXR-520 Core Housing

Core housing supplied with heat resistant core and 90 duro O-ring.



EXR-520

EXB-222 Jam Nuts

Jam nut used on EXT-81 & EXT-82 spuds as well as flexible extensions.



EXB-222

EXR-762S Swivel Connector

Swivel connector used to make up the various SLB flexible extensions.



EXR-762S

EXR-763 Straight Connector

Straight connector used to make up the various SLB flexible extensions.



EXR-763

EXR-764R Sleeves

Sleeve used to retain the hose onto the SLB barb fittings.



EXR-764R

EXR-969K Flexible Extension Assembly Kit

Kit made up of following components for field assembling of flexible extensions:

- 1 each of EXR-520, EXR762S, EXR-763
- 2 each of EXR-764R, EXB-222

EXR-969K1 Flexible Extension Assembly Kit

Kit made up of following components for field assembling of flexible extensions:

- 1 each of EXR762S, EXR-763
- 2 each of EXR-764R, EXB-222



SUPER LARGE BORE (SLB)

CORE HOUSINGS, VALVE ASSEMBLIES, OUTSIDE-IN SPUD, LOADER VALVE



EXR-521

EXR-521 Core Housing

Core housing to be used with EXC-200 spud.



EXM-1000

EXM-1000 Straight Valve Assembly

Straight valve assembly used mostly on scrapers having a threaded rim valve hole of 3/4"-16 thread and an O-ring seal. It consists of EXC-200 spud and EXR-521 core housing.



EXM-1870

EXM-1870 Straight Valve Assembly

Straight valve assembly consisting of EXT-81 clamp-in spud & EXR-520.



EXM-2000

EXM-2000 Swivel Valve Assembly

90° Swivel valve assembly consisting of EXR-525 swivel connector and EXR-520 core housing.



EXR-625

EXR-625 (TR-CH16) Core Housing

Air liquid core housing to be used with EXT-81, EXC-100 rim spuds.



EXR-626

EXR-626 Core Housing Assembly

Straight air liquid valve assembly, consisting of EXR-625 and EXT-81.



EXX-381

EXX-381 Outside-In Spud

Outside-in spud intended for emergency temporary replacement only. NOT RECOMMENDED FOR PERMANENT INSTALLATION.



EXT-999

EXT-999 Loader Valve

Loader dozer valve fits into 11/16"-12 threaded valve hole with O-ring seal. Accepts EXR-520 and other SUPER LARGE BORE fittings.

EXS-85 Screw-in Angle Spud

85° Angle screw-in spud for use where the rim valve hole is a 1/2" NPT thread.



EXS-85

EXS-85D Screw-in Angle Spud

Same as EXS-85 but has additional seal in the form of locking nut with Teflon seal.



EXS-85D

EXS-75 Screw-in Angle Spud

75° Angle screw-in spud for use where the rim valve hole is a 1/2" NPT thread.



EXS-75

EXS-75D Screw-in Angle Spud

Same as EXS-75 but has additional seal in the form of locking nut with Teflon seal.



EXS-75D

EXS-85/1 Screw-in Angle Spud

85° Angle screw-in spud for use where the rim valve hole is a 3/4" NPT thread.



EXS-85/1

EXT-85 Clamp-in Connector

85° Clamp-in connector for application for a 13/16" rim valve hole.



EXT-85

SLB Swivel Angle Connectors

All SLB swivel angle connectors fit onto SLB rim spuds (EXT-81, EXT-82, EXC-100, EXC-155, EXX-381). These swivel connectors are used to join the flexible extensions to the rim spuds. They are available in a variety of angles as shown below:

EXR-525 - 90°
EXR-675 - 75°

EXR-685 - 85°
EXR-670 - 70°

EXR-680 - 80°
EXR-660 - 60°



EXR-525

SUPER LARGE BORE (SLB)

SPUDS



EXDS-210

EXDS-210 Spud

Clamp-in double end spud to fit into rim valve hole of 13/16" supplied with heat resistant Viton grommet.



EXDS-210P

EXDS-210P Spud

Screw-in double end spud to fit into threaded rim valve hole of 1/2" NPT.



EXT-81

EXT-81 (TR-SP8) Spud

Clamp-in spud fits into 13/16" rim valve hole. Supplied with heat resistant Viton grommet.



EXT-82

EXT-82 Spud

Same as EXT-81 except it offers an additional 9/32" height. Supplied with heat resistant Viton grommet.



EXC-100

EXC-100 (TR-SP9) Spud

Screw-in spud fits into rim valve hole of 1/2" NPT.



EXC-120

EXC-155 Spud

Same as EXC-100 but without internal thread.

EXC-120 Spud

Screw-in spud fits into 3/4" NPT threaded rim valve hole.



EXC-200

EXC-200 Spud

Screw-in spud for threaded rim valve hole of 3/4"-16 straight thread. Equipped with O-ring seal. Used with EXR-521 core housing.

EXDS-215 Plug

Plug for EXDS-210 series double spuds.



EXDS-215

EX-445 Valve Cap

Super Large Bore valve cap. Protects threads on the flexible extensions as well as the complete EXR-520 core housing.



EX-445

EX-789-0 Formed Valve

Formed swivel valve assembly for CAT-789, delivered without core housing and spud. Will fit onto EXT-81, EXT-82 & EXC-100 rim spuds



EX-789-0

EX-9002 (Short) / EX-9004 (Long) Valves

Special formed Super Large Bore valves designed specifically for TEREX trucks such as 33-15



EX-9002

Custom Valves

EXACTRA has the ability to produce various custom formed valves.

Please contact us for your specific requirements.



SUPER LARGE BORE (SLB)

INFLATOR ADAPTORS



EX-900S-L

EX-900S-L Inflator Adaptor

Inflator adaptor for SLB line of products. Allows faster inflation and deflation of giant tires. This inflator allows air line connections of either 1/2" NPT male or 3/4" NPT female threads. It also features safety factors inasmuch as the union attaches to the main body by means of a left hand thread thus preventing accidental detaching of the union during the operation of attaching the union to the valve assembly.

The core housing and cap are recessed within the handle to prevent injury to the service man.

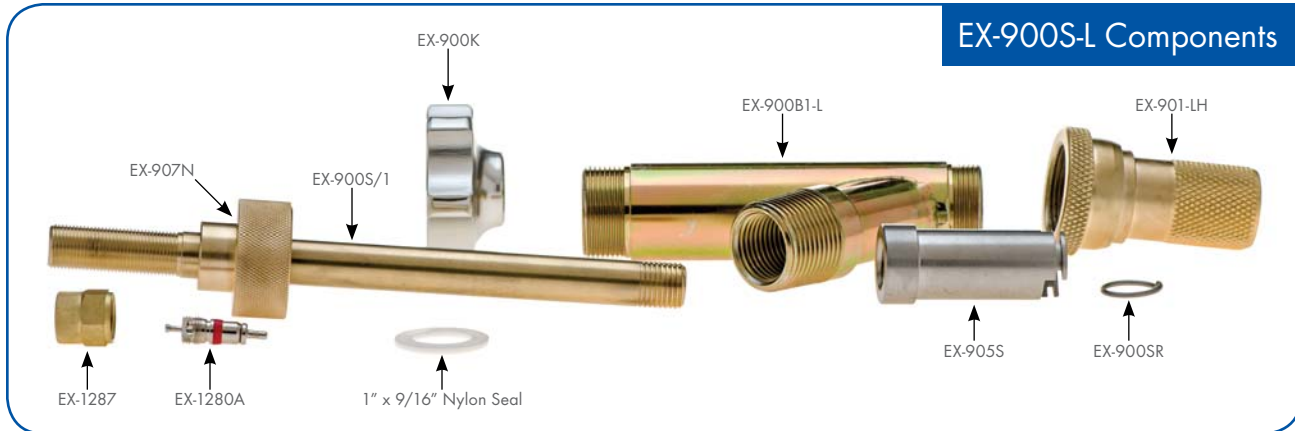

EX-900S-L Components

EX-95-ADK Inflator Adaptor

Inflator adaptor with same features as EX-900S-L but can be used for any of the SUPER LARGE BORE, SUPER EXTRA LARGE BORE and SUPER GIANT BORE simply by attaching the corresponding union.

It is delivered complete with the three unions.



EX-95-ADK

SGB-901-LH

SXL-901-LH

Single-Bend Swivel Valves

The LARGE BORE system is primarily used on tire sizes up to 49" and although it does not require any type of inflation adaptor, it is still most popular on the smaller OTR tires such as those on graders and small loaders or where clearance does not allow for the larger bores to be used.

The Large Bore valves listed on this chart represent only the most popular ones in use. Basically these can be made in any length required as well as various configurations. You should always use the proper valve for the application. The bend on these valves should never be altered to suit an application. The principle of one size fits all does not apply to these valves. If you require a specific bend in a valve please mention so when ordering.

All valves come with heat resistant core and hex cap. On lengths over six inches two lock nuts are furnished. All valves of 4-1/2" or larger in length are supplied with a rubber protection sleeve on the stem. These valves are produced to the T.R.A. specifications where such specifications exist otherwise they are produced on customer's specifications.

All Large Bore swivel valves can be used with any of the rim spuds shown on page 27 of this catalogue.

EXACTRA NUMBER	TR #	BEND ANGLE	LENGTH		HEIGHT	
			INCHES	MM	INCHES	MM
EX-52-2	-	25°	2	50.8	1 1/16	27.0
EX-54-6	-	90°	6	152.4	2 3/8	60.3
EX-58-2-1/2	-	60°	2 1/2	62.7	2 1/8	54.0
EXJ-650	J-650	80°	3 1/8	79.4	1 5/64	27.7
EXJ-651	J-651	90°	4 11/16	119.0	1 17/64	32.1
EXJ-652	J-652	86°	5 1/2	139.7	1 5/64	27.4
EXJ-653	J-653	80°	2 1/2	62.7	1 5/64	27.4
EXJ-654	J-654	60°	3 1/8	79.4	1 5/64	27.4
EXJ-655	J-655	74°	3 1/8	79.4	1 5/64	27.4
EXJ-656	J-656	90°	3 11/16	93.7	2 5/8	66.7
EXJ-657	J-657	80°	4	101.6	1 5/64	27.4
EXJ-658	J-658	80°	5 1/2	139.7	1 5/64	27.4
EXJ-659	J-659	90°	3 1/2	88.9	1 57/64	50.4
EXJ-660	J-660	90°	8 3/4	222.3	1 57/64	50.4
EXJ-668	J-668	90°	4 11/16	119.0	5 1/8	130.2
EXJ-669	J-669	90°	2 1/2	62.7	1 5/64	27.4
EX-3101/1	-	80°	4 1/2	114.3	1 5/64	27.4
EX-3110/1	-	80°	9	228.6	1 5/64	27.4
EXJ-4002.5	J-4000-2 1/2	90°	2 1/2	62.7	1 5/64	27.4
EXJ-4003	J-4003	90°	3	75.2	1 5/64	27.4
EXJ-4004	J-4000-4	90°	4	101.6	1 5/64	27.4
EXJ-4004.5	J-4000-4 1/2	90°	4 1/2	114.3	1 5/64	27.4
EXJ-4005	J-4000-5	90°	5	127.0	1 5/64	27.4
EXJ-4006	J-4000-6	90°	6	152.4	1 5/64	27.4
EXJ-4007.5	J-4000-7 1/2	90°	7 1/2	190.5	1 5/64	27.4
EXJ-4008	J-4000-8	90°	8	203.2	1 5/64	27.4
EXJ-4009	J-4000-9	90°	9	228.6	1 5/64	27.4
EXJ-4010	J-4000-10	90°	10	254.0	1 5/64	27.4
EXJ-4010.5	J-4000-10 1/2	90°	10 1/2	266.7	1 5/64	27.4
EXJ-4011	J-4000-11	90°	11	279.4	1 5/64	27.4
EXJ-4012	J-4000-12	90°	12	304.8	1 5/64	27.4
EXJ-4013	J-4000-13	90°	13	330.2	1 5/64	27.4
EXJ-4016	J-4000-16	90°	16	406.4	1 5/64	27.4
EXJ-4024	J-4000-24	90°	24	609.6	1 5/64	27.4
EXJ-4028	J-4000-28	90°	28	711.2	1 5/64	27.4
EXJ-4029.5	J-4000-29 1/2	90°	29 1/2	749.3	1 5/64	27.4
EXJ-4030	J-4000-30	90°	30	762.0	1 5/64	27.4
EXJ-4032	J-4000-32	90°	32	812.8	1 5/64	27.4
EXJ-4036	J-4000-36	90°	36	914.4	1 5/64	27.4

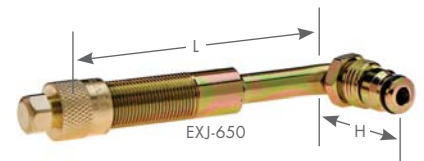

LARGE BORE (LB)

MULTIPLE-BEND SWIVEL VALVES, TURRET VALVES

Multiple-Bend Swivel Valves

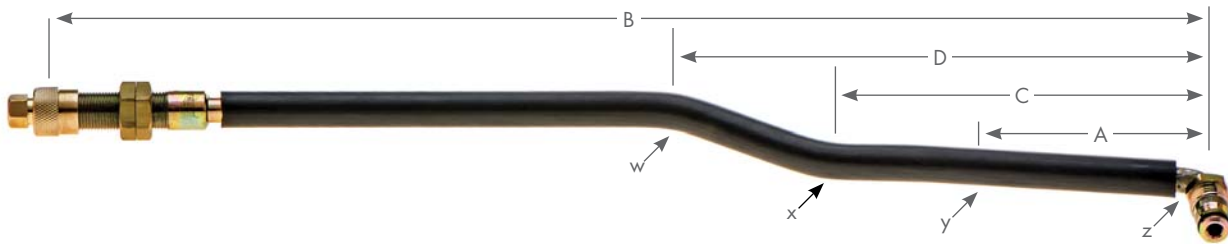

EXACTRA #	TR #	A	B	C	D	W°	X°	Y°	Z°
EXJ-662	J-662	-	14.00	4.50	5.87	20	20	-	90
EXJ-663	J-663	-	25.00	2.00	6.00	8	8	-	90
EXJ-665	J-665	-	32.00	2.00	5.94	13	13	-	90
EXJ-666	J-666	3.28	20.12	4.38	6.22	31	31	6	84
EXJ-5013	-	3.50	14.00	4.50	6.50	30	30	5	85
EXJ-661	J-661	-	4.50	1.88	-	-	8	-	82
EXJ-664	J-664	-	8.75	4.00	-	-	13	-	90
EXJ-667	J-667	-	7.50	3.00	-	-	11	-	90

Turret Valves

The turret type Large Bore valves are primarily used on planetary gear wheels. However they can also be used on a variety of other applications, such as where low clearance does not allow for use of a swivel valve & spud. They are produced to the T.R.A. specifications and can also be produced to customer's specifications. They are designed for use in a standard rim valve hole of 13/16" diameter. These valves with length of 10" or longer should be anchored to the rim.

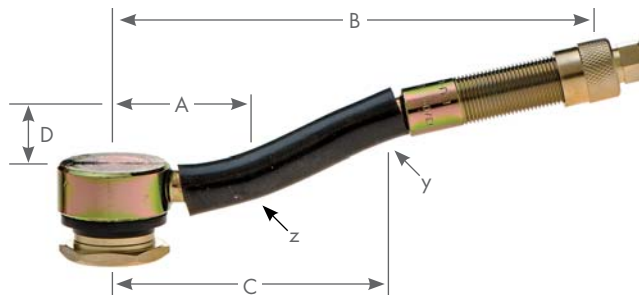

EXACTRA #	TR #	A	B	C	D	Y°	Z°
EXJ-690	J-690	1.25	4.69	2.31	0.56	28	28
EXJ-690B	-	0.75	3.75	1.75	0.56	28	28
EXJ-690B1	-	0.75	3.00	1.20	0.40	28	28
EXJ-690/A	-	0.75	5.00	2.88	0.625	16	16
EXJ-690/7	-	3.50	7.00	4.83	0.56	28	28
EXJ-690/8	-	2.00	8.00	3.33	0.56	28	28
EXJ-691	J-691	0.62	3.31	-	-	-	18
EXJ-691-2	-	0.65	2.65	-	-	-	18
EXJ-691B	-	0.62	8.50	-	-	-	18
EXJ-692	J-692	1.25	4.69	2.31	0.56	18	28
EXJ-693	J-693	0.88	5.00	1.69	1.00	45	45
EXJ-694	J-694	0.78	3.50	-	-	-	28
EXJ-695	J-695	0.81	4.12	2.19	1.00	50	50
EXJ-696	J-696	1.06	4.25	2.06	0.91	42	42
EXJ-697	-	-	5.50	3.50	-	25	-

Screw-On Repair Valves

The Large Bore Screw-On Repair Valve is intended for use on tube type tires and screws onto an SP-1000 tube type spud having threads .482-26 (TR-12V1).

These valves are produced to the T.R.A. specifications, but can also be produced to a customer's specifications.

EXACTRA NUMBER	TR #	ANGLE	HEIGHT		LENGTH	
			INCHES	MM	INCHES	MM
EX-1264	J-1078A	STRAIGHT	5.780	146.8	–	–
EX-1265	J-1078C	90°	1.125	28.58	4.825	122.55
EX-1266	J-1076E	88°	1.375	34.93	3	76.2
EX-1267	J-1076B	86°	1.125	28.58	3.25	82.55
EX-1268	J-1076A	STRAIGHT	4.16	105.66	–	–
EX-1269	J-1076D	90°	2.06	52.32	2.31	58.67
EX-1270	J-1014	STRAIGHT	1.91	48.51	–	–
EX-1271	J-1076C	90°	1.5	3.81	2.825	71.75
EX-1272	J-1078B	82°	1.375	34.93	4.625	117.47
EX-1273	J-1175C	88°	1.375	34.93	4.125	104.77
EX-1274	J-1177A	STRAIGHT	4.5	114.3	–	–
EX-1275	J-1179B	88°	1.37	34.93	5.25	133.35
EX-1276	J-1178A	STRAIGHT	5.28	134.11	–	–
EX-1277	J-1175B	82°	1.25	31.75	4.25	107.95
EX-1278	J-1179A	STRAIGHT	6.4	162.7	–	–

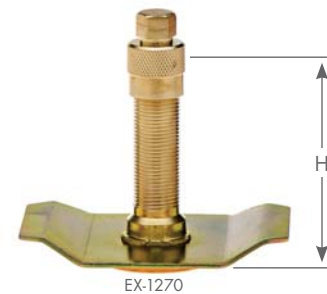

Large Radius High Bend Air Valves

These High Bend valves are used primarily on loaders & dozers where liquid is used as ballast. In order to ensure long life these valves are produced with all brass material. They are supplied with heat resistant core and hex valve cap. The spud is not included.

EXACTRA NUMBER	ANGLE	HEIGHT		LENGTH	
		INCHES	MM	INCHES	MM
EX-HBS 11	90°	11	279.4	1 29/32	48.3
EX-HBS 5 1/2	90°	5 1/2	139.7	2 1/16	52.4



EXT-670 Loader/Dozer Valve

Loader dozer tire valve, fits thread 1 1/16"-12. Delivered complete with heat resistant core, hex cap and O-ring seal.



EX-6047 Tank Valve

Large Bore tank valve with 1/4" NPT thread.



LARGE BORE (LB)

SPECIAL FORMED VALVES

Special Formed Valves

These valves are supplied with heat resistant core and hex cap. These valves are intended as replacement market for Caterpillar trucks. Contact EXACTRA for application guidance.



EXACTRA NUMBER	DESCRIPTION	BENDS	LENGTH	
			INCHES	MM
EX-231-5112	Extension	4	28	711.2
EX-272-7940	Extension	4	15	381
EX-272-7948VC	Valve	4	21	533.4
EX-272-7949VC	Valve	4	29	736.6
EXD-0585EC	Extension	4	17 5/16	439.67
EXD-5008EC	Extension	4	17 13/16	452.37
EXD-7103EC	Extension	4	16 1/4	412.75
EXD-7948EC	Extension	4	21	533.4
EXD-7949EC	Extension	4	29	736.6
EXD-8262EC	Extension	6	30	762
EXD-9903EC	Extension	4	16 7/8	428.75
EXG-0570VC	Valve	5	19 31/32	507.23
EXG-1450VC	Valve	5	32 7/8	835.15
EXG-4985VC	Valve	4	19 3/4	501.65
EXG-5200VC	Valve	5	27	685.8
EXG-5410VC	Valve	5	31 9/16	801.62
EXG-5420VC	Valve	5	33	838.2
EXG-8018VC	Valve	4	26 3/4	679.45
EXG-8019VC	Valve	1	8	203.2
EXG-9440VC	Valve	5	27	685.8
EXG-9470VC	Valve	5	31 1/2	800.1



EX-1302 Tubeless Rim Spud

Tubeless rim spud fits into 13/16" rim valve hole. This spud features a heavier than standard base to allow for a better grip for the tire fitter. Delivered with heat resistant Viton grommet. Will accept all of the large bore swivel valves.



EX-1302

EXC-10 Screw-in Spud

Screw-in spud to fit into 1/2" NPT threaded rim valve hole. Will accept all of the large bore swivel valves.



EXC-10

EX-1305 Outside-in Spud

Outside-in tubeless spud to fit 13/16" rim valve hole. Will accept all of the large bore swivel valves. This spud is intended for emergency temporary replacement only. NOT RECOMMENDED FOR PERMANENT INSTALLATION.



EX-1305

EX-1300 Rim Hole Plug

Rim valve hole plug for 13/16" rim hole.



EX-1300

EXH-4000 Standard to Large Bore Adaptor

Adaptor to convert tubes with SP-1000 spud to accept Large Bore swivel valves.



EXH-4000

EXH-4000/1 Standard to Large Bore Adaptor

Same as EXH-4000 but without bridge washer and nut.



EXH-4000/1

EX-1285 Adaptor (Female)

Female type adaptor to convert large bore to standard bore. Fits .482-26 threads.



EX-1285

EX-AD1 Adaptor (Male)

Male type adapter to convert large bore to standard bore. Fits .302-32 thread.



EX-AD1

LARGE BORE (LB)

STRAIGHT VALVES, CAPS, LONG & SHORT VALVE CORES



EX-3150

EX-3150 Straight Valve with Spud

Straight valve with EX-1302 (TR-SP2) spud, heat resistant core and screwdriver cap. Fits into rim valve hole 13/16".



EX-3150/1

EX-3150/1 Straight Valve (No Spud)

Straight valve complete with heat resistant core and screwdriver cap. Fits into any of the large bore spuds shown on page 27 of this catalogue.



EX-1281

EX-1281 Screwdriver Type Cap

Screwdriver type cap (TR-VC-6) fits .482-26 valve threads.



EX-1283

EX-1283 Hex Cap

Hex head cap (TR-VC-7) fits .482-26 valve threads.



EX-1283P

EX-1283P Plastic Hex Cap

Black, sturdy, plastic hex head valve cap. Fits .482-26 valve threads.



EX-1284

EX-1284 Fork Cap

Valve cap for EX-1285 reducer. Fits .302-32 valve threads. Fork head can be used to remove/insert large bore cores.



EX-1287

EX-1287 Dome Cap

Dome valve cap fits .482-26 valve thread.



EX-1280

EX-1280 Valve Core (Long)

Heat resistant, long valve core (TR-C-2). Fits all large bore valves.



EX-1280A

EX-1280A Valve Core (Short)

Heat resistant, short, valve core (TR-C1) to fit all large bore valves. The body of this core is made of two parts so as to not damage/dislodge the red band seal during installation.

Rigid Extensions

These extensions are made of brass and are used where fitment can be done in a straight line with valve. Care must be taken not to bend these extensions as it would impede the function of the deflector pin. They are delivered with hex cap and 2 lock nuts on extensions over 4 inches. Listed are most popular sizes. Other lengths are available upon request.



EX-2006

EXACTRA NUMBER	LENGTH	
	INCHES	MM
EX-2002	2	50.8
EX-2003	3	76.2
EX-2004	4	101.6
EX-2005	5	127.0
EX-2006	6	152.4
EX-2007	7	177.8
EX-2008	8	203.2

EXACTRA NUMBER	LENGTH	
	INCHES	MM
EX-2009	9	228.6
EX-2010	10	254.0
EX-2011	11	279.4
EX-2012	12	304.8
EX-2013	13	330.2
EX-2014	14	355.6
EX-2015	15	381.0

EXACTRA NUMBER	LENGTH	
	INCHES	MM
EX-2016	16	406.4
EX-2017	17	431.8
EX-2018	18	457.2
EX-2019	19	482.6
EX-2020	20	508.0

Hand Bendable Extensions

These extensions can be hand bent for use where a straight on extension cannot be used. They are furnished with 2 lock nuts and a sealing nut. As the cap and core from the valve have to be removed, they are then transferred to the extension. These extensions should be anchored to the rim. Listed are most popular sizes. Other lengths are available upon request.



EX-3006

EXACTRA NUMBER	LENGTH	
	INCHES	MM
EX-3003	3	76.2
EX-3004	4	101.6
EX-3005	5	127.0
EX-3006	6	152.4
EX-3007	7	177.8
EX-3008	8	203.2

EXACTRA NUMBER	LENGTH	
	INCHES	MM
EX-3009	9	228.6
EX-3010	10	254.0
EX-3011	11	279.4
EX-3012	12	304.8
EX-3013	13	330.2
EX-3014	14	355.6

EXACTRA NUMBER	LENGTH	
	INCHES	MM
EX-3015	15	381.0
EX-3016	16	406.4
EX-3017	17	431.8
EX-3018	18	457.2
EX-3019	19	482.6
EX-3020	20	508.0

Flexible Extensions

These extensions are made with steel-braided, hydraulic type hose and reusable fittings. They are furnished with hex cap, heat resistant core, 2 lock nuts, and a sealing nut. Listed are most popular sizes. Other lengths are available upon request.

The hose can also be ordered separately under part# EX-6000H-SB.



EX-6006HD



EX-6000H-SB

EXACTRA NUMBER	LENGTH	
	INCHES	MM
EX-6005	5	127.0
EX-6006	6	152.4
EX-6007	7	177.8
EX-6008	8	203.2
EX-6009	9	228.6
EX-6010	10	254.0

EXACTRA NUMBER	LENGTH	
	INCHES	MM
EX-6011	11	279.4
EX-6012	12	304.8
EX-6013	13	330.2
EX-6014	14	355.6
EX-6015	15	381.0
EX-6016	16	406.4

EXACTRA NUMBER	LENGTH	
	INCHES	MM
EX-6017	17	431.8
EX-6018	18	457.2
EX-6019	19	482.6
EX-6020	20	508.0

EX-6000K Kit

The kit includes the following:

- 1 ea EX-6000M, 1 ea EX-6000S,
- 2 ea EX-6000F, 2 ea EX-HN1 and
- 1 ea EX-3000N, 1 ea EX3000WT



TRACTOR/GRADER & SMALL LOADERS

AIR WATER VALVES, AIR WATER VALVE EXTENSIONS

EXACTRA NUMBER	TR #	ANGLE	A		B		HOLE	
			INCHES	MM	INCHES	MM	INCHES	MM
EX-670	TR-618A	–	1 7/8	47.6	–	–	0.625	15.9
EX-670R	TR-618AR	–	1 7/8	47.6	–	–	0.625	15.9
EX-672	TR-622A	90°	1 3/4	44.5	4 1/2	114.3	0.625	15.9
EX-678	TR-623A	65°	1 1/2	38.1	2 1/4	57.2	0.625	15.9
EX-679	TR-621A	65°	1 1/2	38.1	3	76.2	0.625	15.9



EX-670

EX-670 Straight Air Water Valve

(TR-618A) Straight air water valve primarily used on farm equipment but also widely used on graders and small loaders. The removal of the CH-3 core housing is done with the use of the EX-700 liquid fill tool which allows for fast filling of tire with liquid ballast.



EX-670R

EX-670R Straight Air Water Valve

(TR-618AR) Same application as that of EX-670 except it is a rubber snap-in type and offers same advantages as that of the EX-670. Maximum cold inflation pressure 65 PSI.

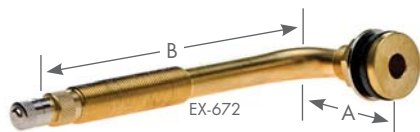

EX-672

EX-672 Air Water Valve

(TR-622A) Suitable for similar application to that of the EX-670 but with a 90° bend and an effective length of 4 1/2".



EX-678

EX-678 Air Water Valve

(TR-623A) Suitable for similar application to that of the EX-670 but with a 65° bend and an effective length of 2 1/4".



EX-679

EX-679 Air Water Valve

(TR-621A) Suitable for similar application to that of the EX-670 but with a 65° bend and an effective length of 3".



EX-5905

EX-5905 Air Water Valve Extension

90° Extension to facilitate access to EX-670 in some specific applications.

TRACTOR/GRADER & SMALL LOADERS

AIR WATER ASSEMBLY, CORE HOUSINGS, RIM HOLE PLUG, BRASS/CHROME VALVES, RIM NUTS

EXR-626 Air Water Valve Assembly

Super Large Bore air water valve assembly. Consists of EXR-625 core housing and EXT-81 (TR-SP8) spud.



EXR-626

EX-683A Core Housing

(TR-CH3) Air water core housing. Fits all air water valves except the Super Large Bore.



EX-683A

EX-CH1 Core Housing

(TR-CH1) Air water core housing to fit old style TR-218A & TR-220A.



EX-CH1

EXR-625 Core Housing

Super Large Bore air water core housing. Fits EXT-81 (TR-SP8) spud.



EXR-625

EX-670P Rim Valve Hole Plug

Rim valve hole plug for 5/8" hole.



EX-670P

JF-944B Brass Valve

Tractor front wheel valve in brass finish.



JF-944B

JF-944N Chrome Valve

Same as JF-944B except in chrome finish.

EX-LN10 Plastic Rim Nut

Plastic rim nut for TR-218A & TR-220A tube valves.



EX-LN10

EX-LN10B Brass Rim Nut

Brass rim nut for TR-218A & TR-220A tube valves.



EX-LN10B

TRACTOR/GRADER & SMALL LOADERS

TANK VALVES, LIQUID FILL TOOL



Tank Valves

Tank valves are used on a great variety of applications, but predominantly on pressure containers where gauging & servicing is required.

EXACTRA NUMBER	THREAD	LENGTH		BORE
		INCHES	MM	
EX-400	1/4" NPT	1 15/16	49.2	Standard
EX-401	1/8" NPT	27/32	21.4	Standard
EX-402	1/8" NPT	1 5/16	33.3	Standard
EX-6047	1/4" NPT	1 19/32	40.5	Large



EX-700 Liquid Fill Tool

Liquid fill tool with 1/2" female NPT thread to attach to any liquid fill systems. It will extract the air water core housing, or the core only in both the Standard and Large Bores to allow for faster filling of the tire.

The components are interchangeable with other similar products.

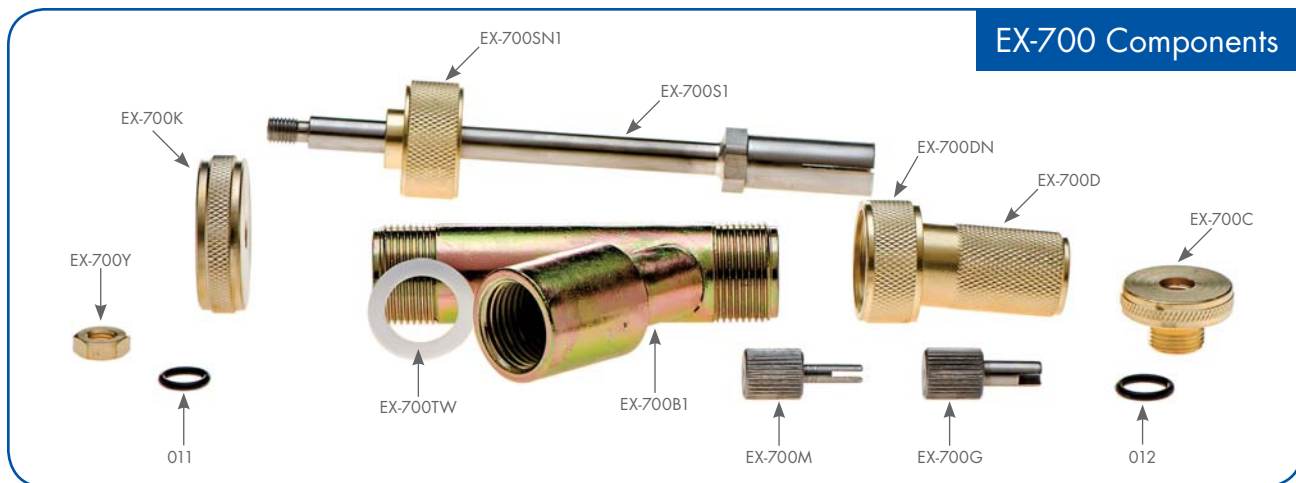

EX-1296 (TR570) Series Valves

These truck valves are primarily for highway type tire applications. They are available with standard grommet and heat resistant valve core. They can be supplied with RED silicone grommet (EX-570GS). They can also be supplied with various bend angles.

EXACTRA NUMBER	TR #	LENGTH		VALVE HOLE	
		INCHES	MM	INCHES	MM
EX-1223R	-	2	50.8	.625	15.9
EX-1296	575	1 1/8	28.6	.625	15.9
EX-1296A	501	1 1/2	31.8	.625	15.9
EX-1296B	500	2	50.8	.625	15.9
EX-1296C	570	3 1/8	79.4	.625	15.9
EX-1296D	571	3 3/8	85.7	.625	15.9
EX-1296E	572	3 3/4	95.3	.625	15.9
EX-1296F	573	4 1/2	114.3	.625	15.9
EX-1296G	574	5	127	.625	15.9
EX-1296H	501 oval	1 1/8	28.6	.625	15.9



EX-1298 Series Valves

These valves are primarily used where heat is a problem on applications such as buses in city operations where there are many stop & go, as well as low profile restricting the flow of cooling air. The prerequisite for these valves is that the surface where the O-ring seats must be clean and free of nicks & burrs.

EXACTRA NUMBER	TR #	LENGTH		VALVE HOLE	
		INCHES	MM	INCHES	MM
EX-1298C	570 EQ	3 1/8	79.4	.625	15.9
EX-1298D	571 EQ	3 3/8	85.7	.625	15.9
EX-1298E	572 EQ	3 3/4	95.3	.625	15.9
EX-1298F	573 EQ	4 1/2	114.3	.625	15.9



EX-540 Series O-Ring Seal Valves

These valves are primarily for Alcoa type wheels and fit into a .389" valve hole. These EXACTRA valves feature a HEX type valve hole in the base so as to allow the service personnel to use an allen key to hold the valve in proper position during fitting. Red Silicone Grommet available (part # EXRG-60).

EXACTRA NUMBER	TR #	BEND	A		B	
			INCHES	MM	INCHES	MM
EX-542	542	-	1.25	31.8	-	-
EX-543	543	-	2.40	60.9	-	-
EX-543C	543C	45°	0.93	23.6	1.43	36.3
EX-543D	543D	60°	0.98	24.9	1.38	35.0
EX-544D	544D	60°	0.98	24.9	1.94	49.3
EX-545B	545B	26°	1.38	35.0	2.20	55.9
EX-545D	545D	60°	0.98	24.9	2.60	66.0
EX-546D	546D	60°	0.98	24.9	3.35	85.1
EX-547D	547D	60°	0.98	24.9	3.78	96.0

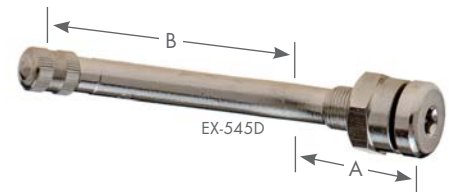

TRUCK & BUS VALVES

V3-20 VALVES, ENKEI VALVES, ALCOA VALVES & LOW PROFILE VALVES, SMALL CLAMP-IN VALVES

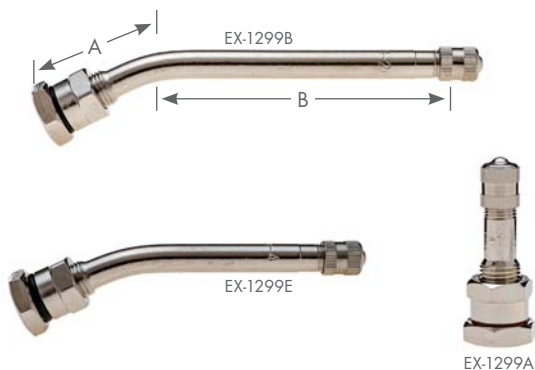

EX-1299 (V3-20) Series Valves

These valves are for metric rim valve hole (9.7mm). Chrome Finish. The products listed below are the most popular sizes. Other sizes available on firm order basis.

EXACTRA NUMBER	ETRTO #	BEND	A		B	
			INCHES	MM	INCHES	MM
EX-1299A	V3-20-1	–	1 3/16	30.16	–	–
EX-1299B	V3-20-6	27°	1 3/16	30.16	3 3/8	85.73
EX-1299E	V3-20-4	27°	1 3/16	30.16	2 3/8	60.33



EX-1296Z (ENKEI) Series Valves

These are high performance chrome plated “No Show” valves designed to fit into a 0.453” rim valve hole. A rubber washer and nut are on the inside.

EXACTRA NUMBER	ETRTO #	BEND	LENGTH		VALVE HOLE	
			INCHES	MM	INCHES	MM
EX-1296Z	WH23A	–	3/4	19.05	0.453	11.51
EX-1296Z1	WH206	–	1 1/4	31.75	0.453	11.51
EX-1296Z2	–	45°	1 3/16	30.17	0.453	11.51

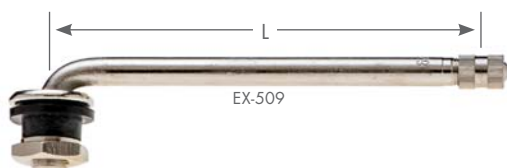

ALCOA Valves & Low Profile Clamp-In Valves

Primarily for use in tubeless truck and bus tires. These double bend clamp-in tubeless valves feature extra low height and fit into a 0.625” valve hole. Rubber grommet available (part # EXRG-48).

EXACTRA NUMBER	TR #	BEND	LENGTH		VALVE HOLE	
			INCHES	MM	INCHES	MM
EX-509	509	90°	4 3/4	120.65	0.625	15.88
EX-510	510	90°	5 1/4	133.35	0.625	15.88
EX-511	511	90°	4 1/4	107.95	0.625	15.88
EX-513	513	90° + 30°	2 5/8	66.68	0.625	15.88
EX-515	515	90° + 30°	3 1/4	82.55	0.625	15.88

Small Clamp-In Valves

These small clamp-in valves are a shorter version of the clamp-in truck valves and are used mostly on cars and light truck applications. Maximum inflation pressure 130 PSI. These valves are supplied with two grommets to allow fitment either in a 0.453” or 0.625” hole.

EXACTRA NUMBER	TR #	LENGTH		VALVE HOLE	
		INCHES	MM	INCHES	MM
EX-416	416	1 1/4	31.75	0.453 / 0.625	11.51 / 15.88
EX-416L	416	2	50.8	0.453 / 0.625	11.51 / 15.88
EX-416S1	416	3/4	19.05	0.453	11.51



Screw-On Repair Valves

These screw-on repair valves for trucks & buses are for replacement of an existing valve on the tube. Simply cut off the damaged valve and screw-on the repair valve. Can be supplied with or without bridge washer.

Can also be used with SP-1000 tube spud.

EXACTRA NUMBER	TR #	LENGTH	
		INCHES	MM
EX-1177A	1177A	3 1/4	82.55
EX-1077A	1077A	4 1/8	104.78
EX-1175A	1175A	4 1/2	114.30
EX-1078A	1078A	5	127
EX-1179A	1179A	5 1/8	130.18



Screw-On Repair Valves (Michelin Type)

These valves fit onto a tube spud having .305-32 threads. They are available in a variety of bends to suit the application. Please refer to the chart for the proper part number relating to the various bends needed.

Rubber Grommet available (part # EX-1295/2).

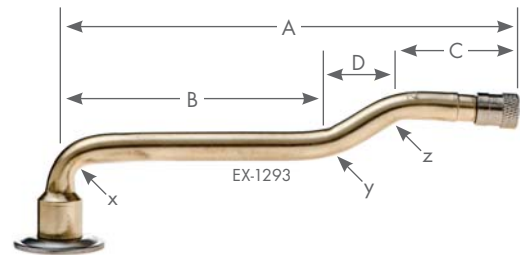

EXACTRA NUMBER	A		B		C		D		x°	y°	z°	BENDS
	INCHES	MM	INCHES	MM	INCHES	MM	INCHES	MM				
EX-1292A	2.50	63.5	—	—	—	—	—	—	86°	—	—	1
EX-1292B	3.00	76.2	—	—	—	—	—	—	86°	—	—	1
EX-1292C	4.00	101.6	—	—	—	—	—	—	86°	—	—	1
EX-1292D	4.50	114.3	—	—	—	—	—	—	86°	—	—	1
EX-1292E	5.00	127	—	—	—	—	—	—	86°	—	—	1
EX-1292G	6.00	152.4	—	—	—	—	—	—	86°	—	—	1
EX-1292T	3.00	76.2	1.10	27.94	1.90	48.26	—	—	86°	16°	—	2
EX-1292N	3.75	95.25	1.90	48.26	1.85	46.99	—	—	86°	16°	—	2
EX-1292P	4.00	101.6	2.25	57.15	1.75	44.45	—	—	86°	16°	—	2
EX-1292Q	4.50	114.3	2.70	68.58	1.80	45.72	—	—	86°	16°	—	2
EX-1292R	5.00	127	3.15	80.01	1.85	46.99	—	—	86°	16°	—	2
EX-1292S	5.50	139.7	3.35	85.09	2.15	54.61	—	—	86°	26°	—	2
EX-1293Q	3.70	93.98	1.60	40.64	1.60	40.64	0.50	12.7	86°	26°	26°	3
EX-1293L	4.00	101.6	1.90	48.26	1.60	40.64	0.50	12.7	86°	26°	26°	3
EX-1293M	4.50	114.3	2.40	60.96	1.60	40.64	0.50	12.7	86°	26°	26°	3
EX-1293N	5.00	127	2.50	63.5	2.00	50.8	0.50	12.7	86°	26°	26°	3
EX-1293R	5.50	139.7	3.00	76.2	2.00	50.8	0.50	12.7	86°	26°	26°	3

TRUCK & BUS VALVES

VALVE EXTENSIONS, FLEXIBLE EXTENSIONS, BENT EXTENSIONS

Truck & Bus Valve Extensions

These extensions are for accessing the inner dual tire valve on truck and buses in order to allow for inflation checks as well as for inflating the tires.

They are available in a variety of lengths shown as effective lengths on the chart. The EX-1500 series are with SHORT collar and the EX-1500L are with LONG collar.

EXACTRA NUMBER	EXACTRA NUMBER	EFFECTIVE LENGTH	
		INCHES	MM
EX-1500	EX-1500L	2	50.8
EX-1501	EX-1501L	3	76.2
EX-1502	EX-1502L	5	127
EX-1503	EX-1503L	3 5/8	92.01
EX-1504	EX-1504L	4	101.6
EX-1505	EX-1505L	1 1/4	31.75
EX-1506	EX-1506L	6	152.4



EX-1504



EX-1504L

Flexible Extensions

The EX-1600 series extensions are made of rubber hose and are used widely on campers and similar vehicles to facilitate access to the inner dual valve. They are delivered with a clamp to secure the extension to the outer wheel bowl.

The EX-1400 series is similar to the EX-1600 series, except it features a steel braided cover on the hose. They are available in a variety of lengths and are supplied with one clip.

EXACTRA NUMBER	LENGTH	
	INCHES	MM
EX-1407	7"	177.8
EX-1407-90	7"	177.8
EX-1407-180	7"	177.8
EX-1410	10"	254.0
EX-1410-90	10"	254.0
EX-1410-180	10"	254.0

EXACTRA NUMBER	LENGTH	
	INCHES	MM
EX-1412	12	304.8
EX-1412-90	12	304.8
EX-1412-180	12	304.8
EX-1414	14	355.6
EX-1414-90	14	355.6
EX-1414-180	14	355.6



1144S clamp
for
EX-1400 series



EX-1407



EX-1407-90



EX-1407-180



EX-1607

Bent Extensions for Standard Bore Valves

Bent extensions for Standard Bore valves.

EXACTRA #	BEND
VE-36-90	90°
VE-36-135	135°



VE-36-135

Snap-In Valves

EXACTRA NUMBER	TR #	LENGTH		VALVE HOLE		MAX INFLATION
		INCHES	MM	INCHES	MM	
EX-412	412	15/16	23.81	0.453	11.5	65 psi
EX-413	413	1 1/4	31.75	0.453	11.5	65 psi
EX-414	414	1 1/2	38.1	0.453	11.5	65 psi
EX-415	415	1 1/4	31.75	0.625	15.88	65 psi
EX-418	418	2	50.8	0.453	11.5	65 psi
EX-423	423	2 1/2	63.5	0.453	11.5	65 psi
EX-425	425	2	50.8	0.625	15.88	65 psi
EX-600HP	600HP	1 1/4	31.75	0.453	11.5	80 psi
EX-602HP	602HP	2	50.80	0.453	11.5	80 psi
EX-670R	618AR	1 7/8	47.63	0.625	15.88	65 psi
EX-801HP	801HP	1 1/4	31.75	0.625	15.88	100 psi
EX-802HP	802HP	2	50.8	0.625	15.88	100 psi



EX-413



EX-600HP



EX-801HP



EX-670R



EX-602HP



EX-802HP

Metal Extension Caps

Metal extensions for light-duty vehicles.

EXACTRA NUMBER	TOTAL LENGTH		EFFECTIVE LENGTH		TYPE
	INCHES	MM	INCHES	MM	
EX-1510	7/8	22.23	5/8	15.88	Standard
EX-1511	1 1/16	26.99	3/4	19.05	Standard
EX-1512	1 9/16	39.69	1 1/4	31.75	Standard
EX-1385	7/8	22.23	5/8	15.88	Dual Seal



EX-1511



EX-1385

Standard Bore Short Valve Cores

EXACTRA #	DESCRIPTION
EX-1320	Short Valve Core for Standard Bore Valves. Nickel Plated.
EX-1320S	Heat-Resistant Short Valve Core for Standard Bore Valves. Nickel Plated.



EX-1320



EX-1320S

Standard Bore Valve Caps

EXACTRA #	DESCRIPTION
EX-1363	Metal Screwdriver-Type Cap for Standard Bore Valves.
EX-1365	Metal Dome Type Cap for Standard Bore Valves.
EX-1375	Black Plastic Cap for Standard Bore Valves.



EX-1363



EX-1365



EX-1375

Standard Bore Valve Caps

EXACTRA #	DESCRIPTION
EX-1312	Metal Heavy Duty Heat Resistant Cap for Standard Bore Valves.
EX-1360	Chrome Hex Cap for Standard Bore Valves



EX-1312



EX-1360

DIAL GAUGES & DIGITAL GAUGES

STANDARD/LARGE BORE DIAL GAUGES, POCKET DIAL GAUGE, DIGITAL PRESSURE GAUGE



EX-1220

EX-1220 Standard/Large Bore Dial Gauge

Standard & Large Bore dial gauge with calibration feature. Equipped with filters for dirt. Can also be supplied with filters for dirt and/or liquids. Replacement elements for these filters are also available. Delivered in a sturdy plastic case.

Operating Range: 0 – 200 PSI.



EX-1220PH

EX-1220PH Standard/Large Bore Dial Gauge

Standard & Large Bore dial gauge with plastic handle and calibration feature. Equipped with filters for dirt. Can also be supplied with filters for dirt and/or liquids. Replacement elements for these filters are also available. Delivered in a sturdy plastic case.

Operating Range: 0 – 200 PSI.



EX-1230

EX-1230 Standard/Large Bore Dial Gauge

Standard & Large Bore dial gauge with pressure reading retention/release feature.

Operating Range: 0 – 160 PSI.



EX-1230PH

EX-1230PH Standard/Large Bore Dial Gauge

Standard & Large Bore dial gauge with plastic handle and pressure reading retention/release feature.

Operating Range: 0 – 160 PSI.



EX-1315

EX-1315 Standard Bore Dial Gauge

Standard Bore dial gauge with dual foot chuck and pressure reading retention/release feature. Delivered in a sturdy plastic case.

Operating Range: 0 – 200 PSI.



EX-1240

EX-1240 Large Bore Pocket Dial Gauge

Large Bore pocket type dial gauge.

Operating Range: 0 – 160 PSI.



EX-1236

EX-1236 Standard Bore Digital Pressure Gauge

Standard Bore digital pressure gauge features reading retention/release button, automatic shut off and dual foot chuck. Equipped with filters for dirt. Can also be supplied with filters for dirt and/or liquids. Replacement elements for these filters are also available. Delivered in a sturdy plastic case.

Operating Range: 0 – 300 PSI.

EX-1235 Large Bore Digital Pressure Gauge

Large Bore digital pressure gauge features reading retention/release button and automatic shut off. Equipped with filters for dirt. Can also be supplied with filters for dirt and/or liquids. Replacement elements for these filters are also available. Delivered in a sturdy plastic case.

Operating Range: 0 – 300 PSI.



EX-1235

EX-1235PH Large Bore Digital Pressure Gauge

Large Bore digital pressure gauge features reading retention/release button and automatic shut off, with plastic handle. Equipped with filters for dirt. Can also be supplied with filters for dirt and/or liquids. Replacement elements for these filters are also available. Delivered in a sturdy plastic case.

Operating Range: 0 – 300 PSI.



EX-1235PH

PRECISION Dial Gauges (160 PSI)

As inflation pressure is one of the most important factors in tire related safety as well as tire longevity, it is vital that air pressure gauges used be reliable and precise. The "PRECISION" line of gauges offer many advantages as follows:

- A button type valve allows the user to retain/release the pressure reading
- Readings in PSI (160) and KPA (1120).
- The gauge is protected against shocks by means of a rubber protector.
- The gauge can be calibrated by means of a set screw in the face of the dial.
- The mechanism is specially designed to allow for gradual movement of the indicator towards the final reading thus having the same effect as a glycerin-filled gauge. Requires approximately 5 seconds to reach precise readings. One of the main reasons for gauges to lose their reliability is the sudden impact on the indicator when taking a pressure reading.
- Equipped with filters for dirt. Can also be supplied with filters for dirt and/or liquids. Replacement elements for these filters are also available.
- Available for Large Bore and/or Standard Bore as shown below.

EX-1800 Large Bore PRECISION Dial Gauge

Large Bore PRECISION dial gauge with 16" hose. Delivered in a sturdy plastic case.

Operating Range: 0 – 160 PSI.



EX-1800

EX-1800PH Large Bore PRECISION Dial Gauge

Large Bore PRECISION dial gauge with 16" hose and plastic handle. Delivered in a sturdy plastic case.

Operating Range: 0 – 160 PSI.



EX-1800PH

EX-1801 Standard Bore PRECISION Dial Gauge

Standard Bore PRECISION dial gauge with 16" hose and dual foot chuck. Delivered in a sturdy plastic case.

Operating Range: 0 – 160 PSI.



EX-1801



EX-1005



EX-1025

Pocket Type Gauges

EXACTRA NUMBER	CALIBRATION	BAR	TYPE	FINISH
EX-1005	10 – 50 PSI	Plastic	Passenger Tire	Chrome
EX-1015	10 – 130 PSI	Plastic	Passenger Tire	Chrome
EX-1025	5 – 45 PSI	Plastic	Air Liquid Tire	Chrome



EX-1250M

Pocket Type Straight-on Gauges

EXACTRA NUMBER	CALIBRATION	BAR	CHUCK TYPE	FINISH
EX-1250	10 – 130 PSI	Delrin	Straight On	Chrome
EX-1250M	10 – 130 PSI	Metal	Straight On	Chrome



EX-1030



EX-1031

Dual Foot Pocket Type Gauges

EXACTRA NUMBER	CALIBRATION	BAR	CHUCK TYPE	FINISH
EX-1030	10 – 130 PSI	Plastic	Angled	Chrome
EX-1031	10 – 130 PSI	Plastic	Straight + 30° Reversed	Chrome



EX-1035P

Dual Foot Gauges

EXACTRA NUMBER	CALIBRATION	BAR	CHUCK TYPE	FINISH
EX-1035P	10 – 130 PSI	Delrin	Angled	Chrome
EX-1036P	10 – 130 PSI	Delrin	Straight + 30° Reversed	Chrome



EX-1255P

Large Bore Swivel Foot Gauge

EXACTRA NUMBER	CALIBRATION	BAR	TYPE	FINISH
EX-1255P	10 – 150 PSI	Delrin	Large Bore - Swivel Foot	Chrome



EX-1036MC

Recalibratable Dual Foot/Swivel Foot Gauges

EXACTRA NUMBER	CALIBRATION	BAR	TYPE	FINISH
EX-1035MC	10 – 150 PSI	Metal	Angled	Chrome
EX-1036MC	10 – 150 PSI	Metal	Straight + 30° Reversed	Chrome
EX-1255MC	10 – 150 PSI	Metal	Large Bore - Swivel Foot	Chrome



EX-1255MC

EX-1200K Tool Kit (OTR Version)

Tire Technicians Tool Kit – OTR version. This kit includes:

- 1 EX-910 high quality tread depth gauge (OTR aluminum body with magnifying lens. Lens is replaceable if it becomes damaged during use)
- 1 EX-1016 large bore core remover
- 1 EX-1021 damaged core remover for large bore application
- 1 EX-1018 large bore hex cap removing tool
- 1 EX-1800PH precision pressure gauge with plastic handle

This gauge features readings up to 160 PSI, is recalibratable via means of a set screw in the face of the dial, is protected against shock by means of a rubber cover, & features a specially designed internal mechanism which allows for gradual movement of indicator to ensure accuracy of pressure reading. The complete kit comes with its own sturdy plastic carrying case with interior foam to protect against damage to items. The kit design allows for the user to add their own items as needed in their respective market.



EX-1200K

EX-1200KT Tool Kit (Commercial Truck Version)

Tire Technicians Tool Kit – Commercial Truck version. This kit includes:

- 1 EX-1420 high quality truck tread depth gauge (Stainless steel body, with metric & inch readings)
- 1 EX-1616 standard bore core remover
- 1 EX-1520S standard bore, 4-way valve tool, removes damaged core as well as non-damaged core, rebuild internal & external threads
- 1 EX-1801 precision pressure gauge with standard bore dual foot chuck
- 1 EX-1285 adaptor to convert large bore to standard bore; this allows the user to take pressure readings with the EX-1801 precision pressure gauge on both large bore as well as standard bore application without the need for a specific large bore gauge

This gauge features readings up to 160 PSI, is recalibratable via means of a set screw in the face of the dial, is protected against shock by means of a rubber cover, & features a specially designed internal mechanism which allows for gradual movement of indicator to ensure accuracy of pressure reading. The complete kit comes with its own sturdy plastic carrying case with interior foam to protect against damage to items. The kit design allows for the user to add their own items as needed in their respective market.



EX-1200KT

EX-LT03 Standard Bore Tube Deflator

Tube deflator for Standard Bore.



EX-LT03

EX-1616 Standard Bore Core Remover

Tool to remove Standard Bore valve cores. Made of plastic handle and hardened steel to ensure longevity.



EX-1616

EX-685 Large/Standard Bore Core Remover

Combination Large Bore & Standard Bore valve core removing tool.



EX-685



EX-1016

EX-1016 Large Bore Valve Core Tool

Special Large Bore valve core tool. Sliding sleeve allows for gripping of the valve core during removal/fitment. (5 1/2" length)



EX-1017

EX-1017 Large Bore Valve Core Tool

Same as EX-1016 except longer. (10 1/2" length)



EX-1018

EX-1018 Hex Head Valve Cap Tool

Large Bore hex head valve cap tool. (6 1/2" length)



EX-1018L

EX-1018L Hex Head Valve Cap Tool

Large Bore hex head valve cap tool. (10" length)



EX-1019

EX-1019 Core Extractor Tool

Large Bore valve core removal tool. (5 1/2" length)



EX-1021

EX-1021 Broken Core Extractor Tool

Extractor tool to remove broken Large Bore valve cores.



EX-609LB

EX-609LB Large Bore Valve Fishing Tool

Fishing tool used to guide the valve into proper place during fitment of tire and tube assembly onto the rim. For Large Bore application.



EX-609

EX-609 Standard Bore Valve Fishing Tool

Same features as that of EX-609LB except it is for Standard Bore application.

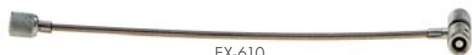

EX-610

EX-610 Standard Bore Valve Fishing Tool

Same application as that of EX-609 except the handle contains a valve core remover feature as well as thread rebuilder. Length is 8".

Also available in 24" length under part number EX-610L.

EX-1520S Standard Bore Valve Core Tool

Four way valve core tool for Standard Bore application. For rebuilding of the inside and outside threads of Standard Bore valves. Easily removes intact and/or damaged valve cores.



EX-1520S

EX-1522 Large Bore Valve Core Tool

Four way valve core tool for Large Bore application. For rebuilding of the inside and outside threads of Large Bore valves. Easily removes intact and/or damaged valve cores.



EX-1522

EX-1525 Large Bore Valve Core Tool

Similar application as that of EX-1522, except that it will not remove broken valve cores. However, it will rebuild inner threads of air water valves such as EX-670 (TR-618A).



EX-1525

EX-595 Tire Tread Depth Gauge

Tire tread depth gauge calibrated in 1/32" units.



EX-595

EX-355 OTR Tread Depth Gauge

Plastic OTR tread depth gauge calibrated in 1/32" units.



EX-355



EX-1420

EX-1420 Truck Tire Tread Depth Gauge

Truck tire tread depth gauge calibrated in 1/32" units and millimeters. Delivered in a plastic case.

EX-910 Professional OTR Tread Depth Gauge

Professional OTR tread depth gauge. Features magnified readings, body made of sturdy anodized finish aluminum, replaceable lens and stainless steel ruler calibrated in 1/32" units and millimeters. Delivered in a leatherette pouch.



EX-910

INFLATORS

EXACTRA inflators are supplied with standard 5' hoses, unless specified differently. Inflators can be ordered in any length. When ordering specify the required length by replacing the "##" that appears after the part number.

For example EX-920-## with 12' hose would be ordered as EX-920-12.



EX-54-920

EX-54-920-## Standard Bore Inflator Gauge

Single inflator gauge for Standard Bore applications. Equipped with 16" hose and calibrated 0 – 90 PSI. Specify required length when ordering.



EX-920

EX-920-## Standard/Large Bore Dual Inflator

Dual inflator for Large Bore and Standard Bore applications. Equipped with EX-4660A & H-5265 closed chucks. Features a bleeder valve and a valve on the manifold to allow for pressure check. Specify required length when ordering.



EX-920/1-3

EX-920/1-3 Standard/Large Bore Dual Inflator

Same as EX-920 but with 3' hose instead of 5'.



EX-920X

EX-920X-## Std/Large Bore Dual Inflator Gauge

Dual inflator for Large Bore and Standard Bore applications. Equipped with a dial gauge. By releasing the control valve lever the tire's inflation pressure is indicated on the dial gauge. Specify required length when ordering.



EX-921

EX-921-## Large Bore Inflator

Single inflator for Large Bore applications. Equipped with EX-4660AFT open chuck. Specify required length when ordering.

EX-922-## Standard Bore Inflator

Same as EX-921 except equipped with H-5265FT Standard Bore open chuck. Specify required length when ordering.



EX-923

EX-923-## Large Bore Inflator Gauge

Single inflator gauge for Large Bore applications. Equipped with EX-4660AFT open chuck. Gauge is calibrated 10 – 150 PSI in 2 PSI increments. Specify required length when ordering.

EX-924-## Standard Bore Inflator Gauge

Single inflator for Standard Bore applications. Equipped with H-5265FT open chuck. Gauge is calibrated 10 – 150 PSI in 2 PSI increments. Specify required length when ordering.



EX-926HD-## Large Bore Inflator

Heavy duty inflator for Large Bore applications. Equipped with 3/8" I.D. hose and ball valve control and EX-4660AFT open chuck. Specify required length when ordering.



EX-927-## Standard Bore Inflator Gauge

Single inflator gauge for Standard Bore applications. Equipped with the EX-6569LO open chuck. Gauge is calibrated 10 – 150 PSI in 2 PSI increments. Specify required length when ordering.



PRECISION Inflator Gauges

The PRECISION series of inflator gauges are of a European style design. They are sturdy, well calibrated, and with proper care will deliver long service. Readings to 170 PSI and 1200 KpA. The handle is ergonomically designed for comfort. It is equipped with a bleeder valve and the gauge is covered with a sturdy rubber protector. Recalibration is possible and requires a specific procedure. They are delivered with a 6' hose but can be supplied with any length requested.

Available with a variety of chucks as shown below:

EX-980C-## PRECISION Large Bore Inflator

For Large Bore applications. Supplied with EX-4660AFT open chuck and 1/4" I.D. hose. Specify required length when ordering.



EX-980CHD-## PRECISION Large Bore Inflator

For heavy-duty Large Bore applications. Supplied with EX-4660AFT open chuck and 3/8" I.D. hose. Specify required length when ordering.



EX-980FT-## PRECISION Large Bore Inflator

For Large Bore application. Supplied with EX-4660AFT open chuck. Specify required length when ordering.



CHUCKS

BALL FOOT CHUCKS, CLIP-ON CHUCKS, SCREW-ON CHUCKS, LOCK-ON CHUCKS



EX-5565

EX-5565 Ball Foot Chuck

Ball foot chuck for Standard Bore. 1/4" NPT female thread.



EX-5567

EX-5567 Clip-on Ball Foot Chuck

EXACTRA #	DESCRIPTION
EX-5567	Clip-on ball foot chuck for Standard Bore. 1/4" NPT female thread.
EX-5566	Replacement clip for EX-5567 chuck.



EX-1586C



EX-1587C

European-style Clip-on Chucks

European-Style Ball foot chucks for Standard Bore.

EXACTRA #	DESCRIPTION
EX-1586C	Closed clip-on chuck for Standard Bore. 1/4" NPT thread.
EX-1586FT	Open clip-on chuck for Standard Bore. 1/4" NPT thread.
EX-1587C	Closed clip-on chuck for Standard Bore. 1/4" Barb.
EX-1587FT1	Open clip-on chuck for Standard Bore. 1/4" Barb.
EX-1587FT2	Open clip-on chuck for Standard Bore. 3/16" Barb.



EX-565

EX-565 Screw-on Chuck

Screw-on chuck with .482-26 thread to fit directly onto the Large Bore valve with the core removed to allow for blast of air to quickly seat the beads. Attaches to any air line having 1/2" NPT thread.



EX-366

EX-366 Lock-on Chuck

Lock-on Large Bore air chuck. Chuck locks on valve when cocked to one side on the threads. Has 1/4" NPT thread.



EX-666

EX-666 Lock-on Chuck (Long Version)

Lock-on Large Bore air chuck. Chuck locks on valve when cocked to one side on the threads. Has 1/4" NPT thread.



EX-4460A

EX-4660A Large Bore Clip-on Chucks

Clip-on Large Bore air chucks. Chuck locks on to valve when cocked to one side on the threads. Has 1/4" NPT thread.

EXACTRA #	DESCRIPTION
EX-4660A	Closed clip-on chuck for Large Bore. 1/4" NPT thread.
EX-4660AFT	Open clip-on chuck for Large Bore. 1/4" NPT thread.

H-5265 Standard Bore Clip-on Chucks

Clip-on Standard Bore air chucks. Securely locks onto the valve when sleeve is pushed forward. Releases when sleeve is pulled back. 1/4" NPT thread.

EXACTRA #	DESCRIPTION
H-5265	Closed lock-on chuck for Large Bore. 1/4" NPT thread.
H-5265FT	Open lock-on chuck for Large Bore. 1/4" NPT thread.



H-5265

EX-5560 Standard Bore Clip-on Chuck

Standard Bore closed clip-on chuck. Locks on automatically when pushed onto the valve. Slide sleeve back to release. 1/4" NPT thread.



EX-5560

EX-6569 Dual Foot Chucks

Straight-on and 30° reverse angle chuck. 1/4" NPT connection thread. Also available with lock-on feature.

EXACTRA #	DESCRIPTION
EX-6569	Straight on + 30° reverse angle dual foot chuck.
EX-6569LO	Straight on + 30° reverse angle dual foot chuck with lock-on feature.



EX-6569

EX-6566 Dual Foot Chucks

Dual foot air chucks for truck & bus tires. 1/4" NPT female thread. Available as closed or open type.

EXACTRA #	DESCRIPTION
EX-6566	Closed Dual foot air chuck for truck & bus tires. 1/4" NPT thread.
EX-6566FT	Open Dual foot air chuck for truck & bus tires. 1/4" NPT thread.



EX-6566

EX-6350LO Dual Foot Closed Chuck

Straight-on and 30° reverse angle closed chuck. 1/4" NPT connection thread and black polyurethane finish for durability.



EX-6350LO

O-RINGS & L-RINGS & GROMMETS

O-RINGS, L-RINGS, GROMMETS



Grommets & O-rings

EXACTRA #	TR #	APPLICATION
EXRG-7	RG-7	EX-670, EX-670P, EX-672, EX-678, EX-679
EXRG-16	RG-16	EXJ-690 Series, EX-9002, EX-9004, EXDS-210 (Viton)
EXRG-22	RG-22	EX-1300, EX-1302, EXT-81, EX-82 (Viton)
EXRG-46	RG-46	EX-509, EX-510, EX-511
EXRG-48	RG-48	EX-513, EX-515
EXRG-60	RG-60	EX-540 Series (Red Silicone)
EX-570GS	RG-15	EX-1296 Series (Red Silicone)
EXX-381G	-	EX-1305, EXX-381
EX-125	-	SXL-1050 (90 DURO)
EX-126	-	SLB Series Swivel Connectors
EX-127	-	EXR-520, EXR-521 (90 DURO)
SXL-124	-	SXL Series Swivel Connectors
SGB-123	-	SGB-110
EX-1295/2	-	Rubber Washer for Michelin Valves EX-1292/1293 series

O-rings

EXACTRA O-rings are manufactured with a formulation of EPDM compound offering excellent resistance to severe cold and hot temperature. O-rings are spliced using a very high quality rubber based cement and cured in a heated press @ 165°C.

Custom sizes available on request.



L-ring Seals

L-ring seals are not meant to correct or compensate for damaged beads. L-ring seals are primarily used to create an air seal where the tire bead meets the wheel. They are particularly useful in the following situations:

- Where the rim butt weld may be irregular
- To correct a minor leak between the bead and rim
- To facilitate bead seating in difficult situations
- Air leakage attributed to rim deformation

EXACTRA #	DESCRIPTION
LR-20	20" L-RING SEAL
LR-24	24" L-RING SEAL
LR-25	25" L-RING SEAL
LR-29	29" L-RING SEAL
LR-33	33" L-RING SEAL
LR-35	35" L-RING SEAL
LR-39	39" L-RING SEAL
LR-45	45" L-RING SEAL
LR-49	49" L-RING SEAL
LR-51	51" L-RING SEAL
LR-57	57" L-RING SEAL
LR-63	63" L-RING SEAL
LR-69	69" L-RING SEAL

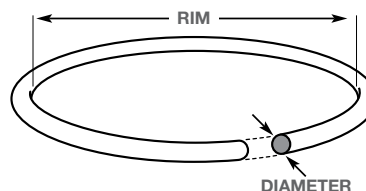

EXACTRA NUMBER	RIM SIZE INCHES	DIAMETER INCHES	PKG	CTN
OR-219	19	0.26	2	24
OR-220TG	20	0.26	2	24
OR-221	21	0.26	2	24
OR-224TG	24	0.26	2	24
OR-225T	25	0.26	2	24
OR-319T	19	0.385	2	24
OR-320T	20	0.385	2	24
OR-321T	21	0.385	2	24
OR-324T	24	0.385	2	24
OR-325T	25	0.385	2	24
OR-329T	29	0.385	2	24
OR-333T	33	0.385	2	24
OR-335T	35	0.385	2	24
OR-339T	39	0.385	2	24
OR-343T	43	0.385	2	24
OR-345T	45	0.385	2	24
OR-349T	49	0.385	2	24
OR-351T	51	0.385	2	24
OR-357T	57	0.385	2	12
OR-445T	45	0.5	2	12
OR-449T	49	0.5	2	12
OR-451T	51	0.5	2	12
OR-457T	57	0.5	2	12
OR-463T	63	0.5	2	10
OR-469T	69	0.5	2	10

WARRANTY

All products sold by EXACTRA are guaranteed to be free from defects in workmanship and materials for a period of 90 days from date of shipment from plant. EXACTRA will replace any item found to be defective, or, at its option, will refund the purchase price of such item, provided that notice of the defect is given by the buyer within 90 days from date of shipment.

The above warranty is in lieu of all other warranties, expressed or implied.

RETURN POLICY

All products being returned for credit must be pre-authorized and in good working condition. Items may be subject to a restocking fee.

CATALOGUE DISCLAIMER

This catalogue represents only a portion of the EXACTRA product offering. Additional products and/or special order items are also available. Please contact us for your specific requirements.

While every effort has been made to ensure the accuracy of the information in this catalogue, please be aware that there may be errors. In addition, products and/or specifications may change. Not all product images may be exactly as shown.



exactra-valves.com

Exactra Inc.

18-8560 Torbram Rd
Brampton, ON L6T 5C9

905.791.1429
info@exactra-valves.com

EX-CAT2014